

THOMAS PAINE

Parent/Student Handbook

2021 — 2022



ELEMENTARY SCHOOL

1801 James Cherry Dr. Urbana, IL 61802

Principal Message

Welcome back to all our returning families and welcome to those who are new to Thomas Paine Elementary School!

I am very excited about this school year and delighted to partner with you on behalf of your child's educational development. My leadership vision is to create collaborative learning opportunities to reveal and encourage the excellence within all our students. It is my intention of accomplishing this vision by facilitating a growth minded learning environment where diversity is embraced and equitable practices prepare all students to excel in school and beyond.

I look forward to your collaboration and support in this endeavor and appreciate your involvement throughout the school year.

*Thomas Magers
Principal*

~ Create collaborative learning opportunities to transform and reveal the excellence within ~



Table of Contents

Page

Vision & Mission	4
Main Office Personnel	5
School Colors	6
School Name & Song	7
Beliefs	8 & 9
Building Access	10
Walker Expectations	11
Drop off & Pick-up	12 & 13
Faculty & Staff	14 & 15
Academic Programs	16 & 17
Acceleration	18 & 19
Response to Intervention (RtI)	20
Internet & Email	21 - 23
Homework Policy	24 - 26
Behavioral Support	27 - 32
Bully Policy	33
Bus Rules & Expectations	34 & 35
Important Reminders	36 & 37
Personal Appearance Guidelines	38
Lunch	39 & 40
Attendance Policy	41 & 42
Nurse's Desk	43 & 44
Contagious Disease Control	45 - 47
Visitors & Volunteers	48 - 50
Mandated Reporters	51 & 52
Crisis Drill Quick Sheet	53
Building Map	54
Class Supply List	55 & 56
School Calendar	57



Vision:

As a community Thomas Paine Elementary School works collectively acquiring knowledge, developing skills, and building character while respecting cultural diversity and individuality to achieve personal greatness to lead to a more equitable society.

Mission:

Thomas Paine School is to foster active engagement in the learning process, to nurture students' unique qualities, and to empower students to become self-directed individuals devoted to making a positive impact on their community, country, and the world.





Main Office Personnel

Principal: Thomas Magers

Lead Secretary: Shawn Hayes

Attendance Secretary: Jill McPike

Custodian: Kevin Sanders

School Telephone Number: (217) 384– 3602

Fax Telephone Number: (217) 344– 1835

School Office Hours: 7:30 AM—4:30 PM (Mon.—Thurs.)
7:30 AM—4:00 PM (Fridays)

School Start Time: 8:10 AM

Breakfast in the classroom: 8:10 AM

All students should be dropped off at the front door

Students will enter the main front doors and go to the gym to remain until 8:10 AM

Students **should not** arrive to school **before 7: 55 AM.**

There is **no supervision.**

Supervision begins at 7:55 a.m. Please do not send or bring your child earlier





We have School Spirit...

We are the TIGER CUBS.

Our school colors are orange and black.



School Name

In 1963, it was the opinion of the school board at that time that schools should be named to recognize national figures.

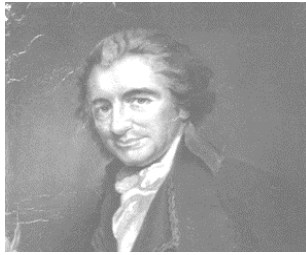

Urbana School District Superintendent James Cherry chose the name of “Thomas Paine” for our school.

School Song

(to the tune of the Notre Dame Fight Song)

Cheer, Cheer for Thomas Paine School
Doing our best is always the rule.
We work hard to make new friends,
Pride in our school will never end.
Though the task be great or small,
Thomas Paine students give it their all.
Students, teachers, parents too, working the whole
year through.



Beliefs

- * All students can learn.
- * Students learn in different ways and should be provided with a variety of instructional approaches in order to support learning, nurture creativity, promote enthusiasm and encourage the enjoyment of learning.
- * Each student is a valued individual with unique physical, social, emotional, cultural and intellectual qualities. By embracing this diversity, students' understanding of different people and cultures is increased.
- * Students' learning needs should be the primary focus of all decisions impacting the work of the school.
- * Individual student performance is increased by fostering active engagement in the learning process, providing challenging expectations and using data to focus instruction.
- *





Beliefs cont.

- * A strong academic, social, moral and emotional foundation enables students to take risks, embrace challenges, be self-directed and be motivated to share their unique qualities with the world.
- * A partnership of teachers, staff, administrators, parents, students and community members provides a supportive secure environment that promotes self-esteem, academic risk-taking and a community of learning.
- * Continuous improvement of our community of scholars enables students to become confident, self-directed, lifelong learners and responsible, productive citizens and leaders.



Building Access

If you are visiting the school, please enter at the main door. Ring the buzzer which is monitored through a video phone system. You may be asked to identify yourself and the reason for your visit. When admitted, the door latch will release the door for you to enter. Please proceed directly to the Main Office to sign in and get a visitor badge.

Anyone in the building without a visible visitor's badge will be stopped.

Dismissal Time

3:00 PM



To ensure the safety of all students and staff, please wait outside during dismissal times!

Please schedule appointments around the dismissal time. You will be asked to wait outside until all students have been dismissed. Patterns of early pick-ups may contribute to excessive absences.

Dismissal Procedures:

- ◆ *All students are expected to leave school grounds promptly*
- ◆ *Students will walk single –file accompanied by supervising teacher(s) to the dismissal area.*
- ◆ *Students will exit safely & quietly.*
- ◆ *Students will walk on the sidewalk to the bus, car, or home.*
- ◆ *Bicycle riders will walk their bicycles when on school grounds.*

Expectations for Walkers & Bikers



Students walking home without an adult escort will leave school from the north door and proceed to the crossing guard. **All students who walk or ride a bicycle must cross at the crosswalk.**

- ◆ *Talk to your children about the routes they should take and tell them they **must cross at the crosswalk.***
- ◆ ***Supervision begins at 7:55 a.m.** Please **do not** send or bring your child(ren) earlier*
- ◆ *Encourage your child(ren) to use the buddy system. It is simply safer when a child is not alone.*
- ◆ *Students should wait on the curb until the crossing guard or safety patrol student(s) tell them to proceed. Remind your child, they should look for traffic with their own eyes as well.*
- ◆ *Any student who can safely handle a bicycle is eligible to ride to school with parental permission.*
- ◆ *Bicycles should be registered with the Urbana Police Department. Having a bike lock is highly recommended. Bicycle may not be stored in the building during the school day.*
- ◆ *Students must walk their bike across streets and cross at a crosswalk just as walkers do. Once on school grounds, students should **WALK** their bike to the school bike racks. All bikes must be locked. **We are not responsible for stolen bicycles.***
- ◆ *Failure to comply with bike rules may result in loss of riding privileges.*

Drop off & Pick-up

School Buses: Use James Cherry Drive to enter the circle drive for loading and unloading.

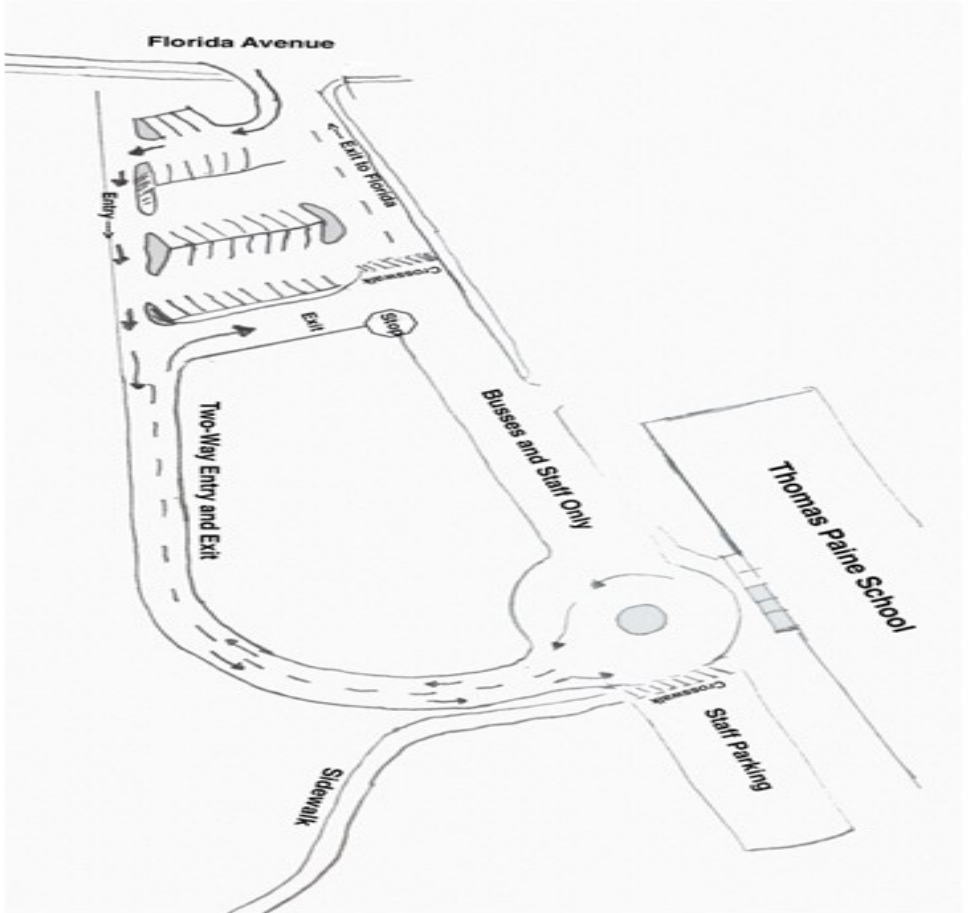

Car riders: Parents will access the car rider lane on the north side of the parking lot. Children can be dropped off or picked up at the circle drive sidewalk. Exit the circle drive using the car rider lane.

Drop off & Pick-up

Only, buses and employee cars will be permitted on the main drive.



Parents may also **PARK and WALK** to the front door when dropping off or picking up. If this is not possible, please use the circle drive for pick-up.

Traffic patterns have been established for the safety of our children. Please avoid accidents by cooperating with these procedures.

Thomas Paine Faculty and Staff

Kindergarten:

Patty Sandberg
Kimberly Murphy
Emily McGraw

First Grade:

Jennifer Kuk
Kaitlyn Scheider

Second Grade:

Sheila Kingry
Kari Surratt

Third Grade:

Chelsea Giasson
Marisah Garcia

Fourth Grade:

Amanda Lappin
Samantha Abbott

Fifth Grade:

Kari Marino
Jackie Martin

Reading Interventionists:

Kim Ford
Michelle Brown
Alaina Nott

Cross Categorical

Helen Edwards
Jeff Hamilton
Lidiya Wang

Chelsey Baker
Sara Roskovic

Librarian:

Miss. Brianna Morgan

Fine Arts:

Martha Churukian, Art
Sarah Tavis, Art
Erica Holmes, Dance/Drama/
Music
Meagan Tipton, Music

Physical Education:

Lindsey Conner

Instructional Coach:

Tara Olsen

Building Floater Sub:

Mae Pelmore



Thomas Paine Faculty and Staff

Special Services Teachers:

Kaitlyn DeHaven

Kayla Goodloe

Speech Pathologist:

Amber Brancaleon

Social Worker:

Megan Berry

Psychologist:

Genevieve Harrington

Occupational Therapist:

Nancy Yeagle

Occupational Therapist

Assistant:

Julie Flessner

Student Engagement Advocate:

TBD

Teaching Assistants:

Kathy Mast

Karen Stephen

Jo Young

Vashaun Wilson

Marita Kheim

Emma Bohn-O'Neil

Kristeen Smith

Sara McPike

Grant Mast

Jaraiya Morris

ASCCP Coordinator:

Skyler Matteson

Volunteer/Mentor Coordinator:

TBD



Academic Programs



Language Arts:

Thomas Paine Elementary School has a comprehensive language arts program. The Daily 5/CAFÉ and Writers Workshop provide the framework for our Balanced Literacy Program. **Fountas and Pinnell grade leveled readers** are used in grades K-5 for our 90 minute literacy block.

Math:

Our core math program is **Eureka Math** for grades K-5. Each grade level is assessed on the math exit expectations throughout the school year.

Physical Education:

Students have a minimum of PE twice weekly. For your child's safety, tennis shoes are required. The curriculum focuses on fitness, wellness, teambuilding and cooperation.

Science & Social Studies:

Our school follows the current Illinois Standards. A variety of texts and other supplemental resources are used.

Fine Arts:

Thomas Paine has a core curriculum in fine arts for the areas of music, art, dance & drama taught on a rotation basis.



Academic Programs



Student Activities:

- ◆ Student government
- ◆ Young Authors
- ◆ Safety Patrol and Band & Strings (5th grade only).
- ◆ Battle of the books for grades 3rd, 4th and 5th

Assessment:

All students are assessed (2) times a year fall and spring using:

- ◆ Fountas & Pinnell Benchmark Assessment Systems (BAS) to determine students independent and instructional reading levels.

All students are assessed (3) times a year fall, winter, and spring using:

- ◆ Mathematics Computation Administration and Scoring Guide (M-Comp) determine students computational skills in grades 1st—5th. AIMsweb Early Numeracy, Kindergarten only.

Teachers routinely monitor student growth using informal assessments and student work samples

Student Progress:

Reported to parents each school quarter by way of report cards. Formal parent conferences are held twice a year, once each semester. **Please make conferences a priority. It is an optimal time to hear from your child's teacher (s).** Other conferences may be scheduled at the request of parents or teachers at any time during the school year.



Academic Programs



Acceleration Policy:

The Illinois Acceleration Placement Act (Public Act 100-0421) was signed into law on August 25, 2017 and took effect on July 1, 2018.

What are the most common types of Acceleration?

Definitions

Accelerated placement is the placement of a student in an educational setting with curriculum that is usually reserved for students who are older or in higher grades than the student.

Accelerated placement includes, but may not be limited to: early entrance to kindergarten or first grade, accelerating a student in a single subject, and grade acceleration.

Early entrance to kindergarten is the admission to kindergarten of a student who: (a) will not be five years of age on or before September 1 of that school term; or (b) is admitted prior to the dates established in the School Code based upon an assessment of his or her readiness to attend school.



Academic Programs



Academic & Social Emotional Growth Response to Intervention (RtI)

Teachers meet routinely with the principal and support staff to review academic progress and social emotional growth of students. Parents are invited to attend these meetings to share student's strengths and areas of concern they may have as well.



Parents are also highly encouraged to contact the principal or classroom teacher with questions and concerns or to request a meeting if one has not already been scheduled.

Academic Programs



District Internet and E-mail Rules

Students are responsible for good behavior on school computer networks at all times. Communications on the network are often public in nature. General school expectations for behavior and communication apply.

The network is provided for students to conduct research and communicate with others as directed. Access to network services are given to students who agree to act in a considerate and responsible manner. Parent permission is required.

******Access is a privilege – NOT A RIGHT******

Individual users of the District computer networks are responsible for their behavior and communications. It is presumed that users will comply with District standards and will honor the agreements they have signed. Beyond the clarification of such standards, the District is not responsible for restricting, monitoring or controlling the communications of individuals utilizing the network.

Network storage areas may be treated like school lockers. Network administrators may review files and communications to maintain system integrity and ensure users are using the system responsibly. Users should not expect files stored on District servers will always be private. During school, teachers of younger students will guide them toward appropriate materials. Outside of school, families bear the same responsibility for such guidance as they exercise with information sources such as television, telephones, movies, radio and other potentially offensive media.

Academic Programs



Online Rules



Personal Safety & Respecting Privacy

- ♦ I **will not** share my or any other person's address, passwords, ID's, telephone number, parent's work address/ telephone number, the name and location of my school or other personal information. If participating in an approved classroom project, name and location of school may be used.
- ♦ I will tell my teacher right away if I come across any information, language or images that makes me feel uncomfortable. It is not my fault if I get a message like that.
- ♦ I will **never** agree to get together with someone I "meet" online.
- ♦ I will **never** send a person my picture or anything else without first checking with my teachers and parents.
- ♦ I **will not** respond to any messages that are mean or use bad language.
- ♦ I **will not** give out a credit card number online, subscribe to any services or order any materials or services on the Internet.
- ♦ I will respect individual's rights to privacy and to freedom from intimidation, harassment, and unwarranted annoyance.
- ♦ I recognize the limitations to privacy afforded by electronic services.

Homework Policy



Homework is defined as specific tasks related to the National Core Standards and district specific curriculum that should be completed during non-school hours.

Homework is assigned to:

- Provide practice, review, and enrichment of skills that have been taught in class.

- Develop independence, individual study skills, and personal responsibility while reinforcing skills and concepts.

- Foster a home-school connection and provide parents with the knowledge of what their children are learning in school.

We ask parents to provide a space and quiet time for your child to complete their homework. We also ask that you monitor the completion and return of all homework, sign when necessary. Parents are strongly encouraged to contact your child's teacher if there are concerns or questions related to homework.

The expectation is: ALL students will complete homework.



Teachers + Parents = SUCCESS!

Homework Policy



Kindergarten	<p>Homework will be sent home weekly and should not exceed 20 minutes. It is expected to be returned to school by the assigned date, unless otherwise noted on assignment.</p> <p>Please read with your child 10 minutes every night and complete reading log.</p> <p>Projects may be assigned during the year.</p>
1st Grade	<p>Homework will be assigned daily (M—Th) and should not exceed 20 minutes. It is expected to be returned the following school day, unless otherwise noted on assignment.</p> <p>Check student's <u>Take Home Folder</u> daily.</p> <p>Homework may include literacy, math, science, and social studies activities.</p> <p>Read nightly, complete, and return weekly reading log.</p>
2nd Grade	<p>Homework will be assigned daily (M—Th) and should not exceed 20—30 minutes.</p> <p>Homework folders will be sent home daily (M—Th).</p> <p>Homework is expected to be returned the following school day.</p>



Teachers + Parents = SUCCESS!

Homework Policy



3rd Grade	<p>Homework will be assigned daily (M—Th) and should not exceed 40 minutes. It is expected to be returned the following school day, unless otherwise noted on assignment.</p> <p>Assignments may include math, spelling, and reading logs.</p> <p>Parents will be expected to sign the reading log.</p>
4th Grade	<p>Homework will be assigned and should not exceed 60 minutes. It is expected to be returned the following school day or by Friday (please refer to teacher newsletter).</p> <p>Assignments will include math, spelling, reading, science, and social studies activities.</p> <p>Parents will be expected to sign homework.</p>
5th Grade	<p>Homework will be assigned daily (M – F)/ weekly and should not exceed 90 minutes. A typical night of homework may include: reading log, math worksheets, and possible study guide for upcoming test(s).</p> <p>Parents are expected to sign homework.</p>



Teachers + Parents = SUCCESS!

BEHAVIORAL SUPPORTS

Thomas Paine is a PBIS School

Positive Behavioral Interventions and Supports (PBIS) is a proactive systems approach to establishing the behavioral supports and social culture needed for all students in a school to achieve social, emotional, and academic success. [Illinois PBIS Network](#)

Designing Schoolwide Systems for Student Success

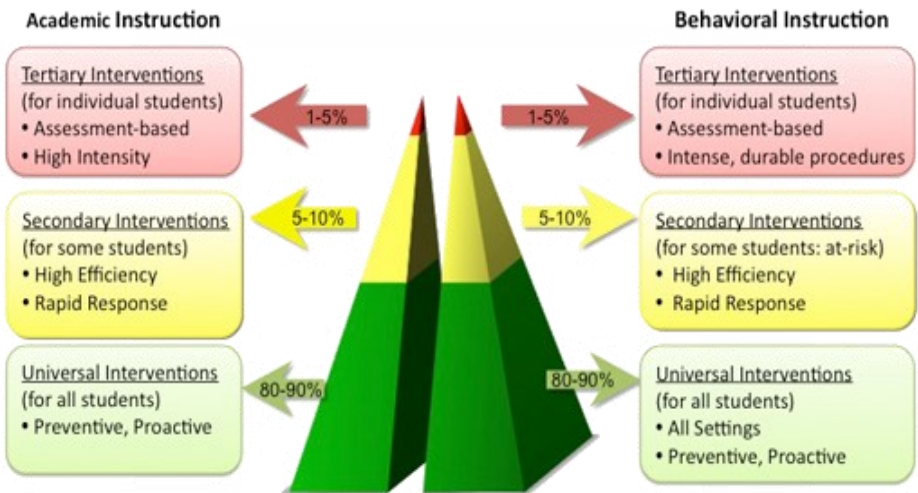

Expectations for Positive Student Behavior

Thomas Paine Elementary School rules are based on three expectations that we believe support learning. At school, these three expectations will be taught and practiced.

Teachers will provide each family a classroom behavior management plan.

Positive Behavioral Interventions & Supports

At Thomas Paine Elementary all individuals will practice safe, responsible, and respectful behavior. As part of teaching and practices, students and teachers will treat each other safely and respectfully. This is the foundation for PBIS and our anti-bullying policy.

As a proactive measure to teach the Illinois Social Emotional Standards, all students are specifically taught the school expectations and participate in weekly **Second Step** lessons focusing on respect, sharing, friendship, and more.

Thomas Paine School's Expectations





Be RESPECTFUL
Be RESPONSIBLE
Be SAFE

Incentives:



Praise
Celebrations
Monthly incentives
School store purchases
Positive office referrals

PBIS MATRIX

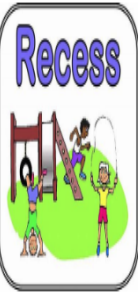
	All Settings 	Hallways 	Restrooms 	Lunchroom 	Recess 
Be Respectful	Level 1 voice Use kind words Keep hands, feet and objects to self	Level 0 voice Walk to the right Hands to your sides or behind your back	Level 0 voice Respect others privacy Quick, Quiet, and Clean	Level 2 voice Raise your hand if you need something Use kind words	Level 4 voice (outside) <input type="checkbox"/> Level 1 voice (inside) Include others Play safely at all times Use kind words If it's on the ground it stays on the ground
Be Responsible	Listen, think and follow directions Keep the school clean Participate in learning Have your body in a listening position.	Keep hallways clean Finger wave to friends Do the right thing	Do the right thing Flush, wash hands, throw paper towel away Let teacher know if something needs attention	Stay at your assigned table The card you choose is the card you use Clean up after yourself Leave all food and utensils in lunchroom	Use equipment properly Return equipment Let an adult know if there are any problems
Be Safe	Keep hands, feet and other objects to self Treat others the way you want to be treated Badge Check	Walk at all times Go straight to your destination Keep outdoor doors shut and don't open for anyone	Wait your turn Walk Do the right thing	Have your lunch card ready. Eat your own food Bring what you need with you	Save food for the lunch room Use equipment for its intended purpose Badge Check

Consequences

Timeout

Teacher Partner

Loss of Privileges/Detention

Office Referrals & other disciplinary actions

Response to Intervention → Behavior Plans

Bully Prevention Lessons & Curriculum:

S.W.A.T.



All students are taught to use the acronym “SWAT”. Tell the peer to **STOP**, **WALK AWAY** and **TELL** an adult.

Goal: Teaching all students responsible behaviors for all settings.

Positive Behavioral Interventions & Supports

Thomas Paine School Expectations

Be RESPECTFUL

Be RESPONSIBLE

Be SAFE

Interventions offered to help students through PBIS:

If a student does not follow the expectations, consequences will be determined based on the following criteria:

- ⇒ Developmental age, seriousness of offense, frequency of behavior, intent, and other factors.
 - ⇒ **Conference** with teacher, peer, principal or another adult
 - ⇒ **Loss of privilege immediately**
 - ⇒ **Detention**—served during lunch or afterschool
 - ⇒ **Other Disciplinary Actions**—may be assigned at the discretion of the principal, including an out-of-school suspension for serious behavior infractions or chronic problems.

Communication:

Parents will be notified by the teacher or principal when consequences are given for inappropriate behavior. The following notification will be provided: email/dojo, phone, text or letter sent home.



Positive Behavioral Interventions & Supports

Thomas Paine School Expectations

Be RESPECTFUL

Be RESPONSIBLE

Be SAFE

Additional interventions to help students through PBIS:

- ⇒ **CICO (Check-in/Check-out):** Our goal is to provide additional support early for students experiencing challenges. With parent consent, students receive intervention support with increased adult attention, frequent feedback about behavior and academics, and additional positive reinforcement.
- ⇒ **Social Work Groups:** Students are identified to receive small group interventions with the social worker or Student Engagement Advocate.
- ⇒ **Social Academic Instruction Groups (SAIG):** Students are assigned to meet weekly with a group to work on specific skills (i.e., organization, following directions, getting to school on time, homework completion, etc.).



BULLY PREVENTION

Reports or observations of an individual not feeling safe or treated respectfully

The following steps and/or interventions shall occur:

Teachers will:

- ◆ Speak with students individually about expectations.
- ◆ Support students in problem-solving and how to act/react to specific situations.
- ◆ Listen and document all concerns.
- ◆ Inform parents of next steps regarding the schools' actions in addressing the behavior. **Referral to social worker may be required.**
- ◆ Share all documentation of concerns and actions with the principal.
- ◆ Monitor behavior and follow up with successes and/or continued parent concerns.

Students will:

- ◆ Use **S.W.A.T.** However, if the situation is a serious safety concern, students should **tell an adult immediately.**



Bus Rules and Expectations

Riding the school bus, whether on a regular route each day or on a field trip, students are expected to follow the expectations below:

Parents are urged to encourage good bus riding habits to ensure the safety of all students.

- Respond promptly to instructions when given.
- Be completely silent when the bus stops at railroad crossings.
- Do not bring inappropriate materials (i.e. tobacco and related material, alcohol, and other prohibited items) onto the bus, as designated by School Board Policy. As well as, animals, oversized objects, glass containers, etc.
- Do not eat or drink while on the bus. Food and drinks should be stored in closed containers or packages during the bus ride.
- Use ordinary conversation with peers and adults. Horseplay, unruly behavior, fighting, abusive and obscene language or gestures are unacceptable. Kicking, hitting, pushing, spitting, yelling or screaming, littering or other inappropriate behaviors are forbidden.





Bus Rules and Expectations

- Keep feet, backpacks, and other items within the seating areas at all times. The aisles and stairwell must be clear of items and objects at all times.
- All body parts must be kept inside the bus window at all times.
- Remain seated in the same seat, facing forward until the bus reaches your stop.
- Not to vandalize or damage the bus seats in any way.
- Be at the bus stop 5 minutes before the scheduled pick up time.
- Students should get on and off the bus only at their designated stops.

Failure to follow expectations may result in a range of consequences up to and including suspension from transportation.

Important Reminders

It is not wise for students to carry cell phones to school nor are they permitted to use cell phones at school. If students bring a cell phone, they should keep it turned off and in a safe place. **We are not responsible for lost or stolen phones.**

If students choose to violate cell phone expectations, the following will occur:

- 1st violation— Warning
- 2nd violation— teacher will confiscate phone and return at the end of the day
- 3rd violation— Confiscated, given to administration for parent to make arrangements to pick-up.

Students **should not bring** electronic devices such as: iPods, MP3 players, and PSPs, trading cards, fidgets or other toys. Those items will be kept by the teacher for the day. If the problem persists, parents will be expected to pick up the items from the Principal.

Students should not bring balls or other play items. The school provides balls and equipment for recess and PE. Items brought to school will be held by the teacher or principal until it is appropriate to send them home or have a parent pick them up.

Students may **NOT** bring personal athletic equipment to school. These items may present safety hazards or distractions.



Skate boards are not allowed. They are not safe on either the school grounds or inside the school.

More Reminders

Student Phone Use

Students are not permitted to use the phone at school unless there is an emergency situation.

Plans should be made *before* children come to school regarding who is picking them up and where they are to go after school, as should plans for their after-school activities. Please notify the school office if there is a change. We will not allow someone else to pick up a child without authorization and proper documentation.



BEFORE and AFTER School Child Care

Parents who need before or after school child care should contact the “Before and After School Child Care Program” directly at 384-3536.



Skylert – School Messenger

Skylert, the district messaging system, allows us to keep parents informed. We are able to efficiently call parents to announce emergencies, school closings, or special events. You will receive phone calls, email and/or text messages. **Please update phone numbers and email addresses so we may keep you informed.**

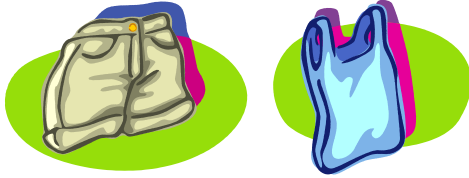

Personal Appearance Guidelines:

- Students must wear **tennis shoes** for PE.
- If students wear flip flops or sandals, they should bring an extra pair of shoes in the event the flip flops break.
- Student pants, skirts, shorts, must rest at least on the waist and must cover the legs to at least the length of the student's fingertips when extended while standing, approximately mid-thigh. Students must not wear pajamas, pajama pants or slippers to school unless it is a classroom or school event.
- Shirts, blouses and tops must be long enough to cover the midsection (front and back) when the student is in a standing or sitting position.
- Hats, hoods, bandanas, scarves, gloves, sunglasses, and do-rags must be removed as soon as a student enters the building and shall not be worn or displayed until after the student leaves the building.
- Spaghetti straps are not allowed for grades 3-5.
- Any clothing with writing and/or pictures on it must not have profanity, inflammatory messages, obscene language or gestures or show violent or inappropriate acts.



Lunch

Breakfast & Lunch Program:

Children may buy lunch on a daily, weekly, or monthly basis. Please make checks payable to Urbana School District #116. A monthly menu will be sent home and is posted on the District's web site. Thomas Paine and all Urbana Elementary Schools are Title I schools; therefore all students are eligible for a free breakfast and several may be eligible for free or reduced price lunch. Please check with the front office regarding the appropriate paperwork to determine your eligibility.

Lunch Hours:

11:10 AM — 12:55 PM

Applications for free and reduced price meals (lunch) are available in the school office throughout the year upon parent request.

⇒ General Pricing:

⇒ Breakfast: \$1.00

⇒ Lunch: \$1.75

⇒ Milk only: 30¢ per carton



If It Is Raining or Cold...

On bad weather days, such as in the case of rain or if the wind chill/temperatures are below 20 degrees Fahrenheit, students will stay inside during recess.

Lunch Program:



Students have 45 minutes for lunch and recess. Depending on the weather, students will play “inside” or go “outside” for recess. Students are expected to observe school expectations concerning good manners, cooperation, and play at all times.

Lunch Supervisors are in charge during the lunch periods because teachers are not on duty. The Lunch Supervisors expect students to follow the expectations that apply in the cafeteria and on the playground.

Students must follow the Lunch Supervisors’ directions at all times.

Students are allowed to talk quietly in the cafeteria.

Loud talking or shouting are not acceptable. When the noise volume becomes too loud, the lunch supervisor may ask students to **remain silent** for a number of minutes.

Students are to remain seated in the cafeteria until directions are given to gather trash and line up.

Students are to play cooperatively at recess.

Shoving, hitting, threatening, or fighting will not be tolerated. These behaviors will result in loss of lunch recess or other possible disciplinary consequences.

On good weather days, ALL students will go outside for lunch recess.

Children may not leave school grounds during lunchtime without written parental permission and supervision.

Attendance Policy

Excused Absences:

The maximum number of excused absences allowed in a semester is **eight (8)**.

Parents may request that an absence be excused for the following reasons:

- ♦ personal illness, family illness, medical/dental appointments, religious holidays, and funerals. Building administration has the final authority to determine whether or not any absence will be excused.

Once a student has accumulated **eight (8)** absences per semester, any **additional absence will be considered unexcused** and handled as an unexcused absence. Excluded from this policy shall be absences which are verified by a doctor's statement. The doctor's statement must be an original copy signed by a licensed medical professional. It must include the date(s) of the student's relevant absence(s).

Unexcused Absences: Students **exceeding five (5) unexcused absences** per semester will be reported to the Regional Superintendent as chronically truant. Continued patterns of excessive excused or unexcused absences may result in a parent meeting with the school's Attendance Review Team, referral to the Regional Office of Education Truancy Officer and/or a referral to the Champaign County State's Attorney.



Early Pick-up:

PLEASE avoid picking students up early unless it is an emergency. At the end of the day, students will miss instructions regarding homework or plans for the following day. Patterns of early pick-ups may contribute to excessive absences.



School Tardiness

It is important that your child arrives at school on time. **Class instruction begins at 8:20 AM.** Students who are late to class miss valuable instruction time and their late arrivals interrupt the education of their classmates.

If your child is going to be late, call the office to let us know and give us your child's lunch choice so we can be accurate with the lunch count. If lunch count information is not provided, your child will receive the Sunbutter option for lunch on that day.

From the Nurses' Desk



It's that time of the year again when kids



are heading back to school! In the office, we find ourselves seeing students

with scraped knees, upset stomachs, headaches, and other maladies associated with the school day and playground mishaps. Here are a few reminders to make sure students are taken care of in the best possible way.

- ◆ **Help the school keep others healthy. Don't send your child to school sick, especially if he is running a fever.** The student must be fever-free for 24 hours before returning to school.
- ◆ In addition, notify the nurse or main office if your child develops an infectious disease or condition such as pinkeye, chickenpox, or head lice.
- ◆ Keep your child up to date on immunizations. Make sure your child has all the appropriate shots and boosters for their age, and give a copy of those records to the school each year.
- ◆ **Registering Students entering K, Gr. 2, Gr. 6-** The Illinois State Board of Education requires students in these age groups have an oral health examination.



From the Nurses' Desk



Registering students entering Early Childhood, K, Gr. 6, Gr. 9-:



Students entering these age groups have a physical exam on file with the school district prior to enrolling. *Students who do not have physical exams by the first day of school will not be allowed to attend school. This policy will be strictly enforced.*

- ◆ Update emergency contact information. The school nurse should have a way of contacting you in the event of an emergency, as well as a back-up contact should you be unavailable.
- ◆ Update medical information on a regular basis. If your child has a chronic illness, such as asthma, medication and physician's instruction should be on file in the office.

Medication

Prescription drugs will be given only with written authorization from a physician; doctor's authorization and orders for administration are provided.

- ◆ **Must be documented annually using** the correct Urbana School District form. Please ask the Thomas Paine secretary for the form.
- ◆ **Original** containers with labels must be provided for the school. Most pharmacies will be cooperative in giving you an extra container labeled for the school.

Contagious Disease Control



- ♦ **If your child requires asthma medications, you may wish to request that your doctor write a prescription for a second set that can be left at school (again with original labeling).**

Keeping your child healthy and able to attend school will make their time in class go much easier and be more enjoyable for all involved.

Parents should examine their children every morning before sending them to school to see if they show any symptoms that may indicate the onset of a contagious disease. Some symptoms that may alert you to an oncoming illness are: red, watering, eyes; nausea, vomiting, or diarrhea; sore throat; earache or drainage from the ear; rash; **fever of 100.0 degrees; persistent runny nose, coughing or sneezing; live lice.** It is advised that you consult with our child's Physician prior to sending your child to school should (s)he experience any of these symptoms.

The requirements for re-admission to school after a contagious disease are listed below. These requirements are subject to change by the State Department of Public Health. If you have questions concerning these or other requirements, you may contact the school nurse through the school.

Contagious Disease Control

Fever	A child should not be sent to school if (s)he has a temperature of 100.0 degrees or greater. (S)he may return to school when the fever has ceased for 24hrs.
Pink Eye	Students may return to school 24 hours after they begin to take medication.
Impetigo	May attend school under a doctor's care
Ring-worm	May attend school under a doctor's care
Mumps	Excluded 9 days and until all swelling is gone
Chicken Pox	Excluded 8 days after eruption
Scabies	May attend after being treated for 24 hours with effective insecticide, all family members are treated with the insecticide, and clothing and bedding are laundered.
Viral Rash	Excluded until under a doctor's care
Head Lice	Follow the instructions of the school nurse regarding shampooing, etc. <u>Upon a re-infestation during the school year, a student will be allowed to return to school following an examination by a Nurse and an indication the student is nit free.</u>



*Any child who becomes
ill or is
injured at school must
be picked up by a parent
or designated adult un-
less the school office re-
ceives specific instruc-
tions, in writing, from
the parent to do other-
wise.*





Parents are welcome to visit and volunteer in classrooms. Please see the volunteer coordinator, Tom Howley (thowley@usd116.org), prior to volunteering or visiting for extended periods. There is specific paperwork and district policy that is required to ensure the safety of all students.

Depending on the reason for your visit, you may wish to consult with the teacher regarding the classroom schedule.

It is important the teacher and students are not interrupted during instructional time. Therefore, interactions with all students should be minimal. Please follow the teacher's expectations to ensure the classroom routine is not disturbed.

If you have questions or want to speak with the teacher, please schedule an appointment outside their student contact time. Teachers may have before school and/or after school duties to consider as well.

Parents are welcome to visit with their child(ren) during the lunch period.





Thinking about Volunteering?

We would love to have you! (You don't have to belong to PTA or attend meetings.) Please call the school for more information.

Parent Chaperones and Volunteers

Parents who chaperone Thomas Paine students - or volunteer in other ways are expected to make other arrangements for younger siblings when they are "serving" in those capacities. It is imperative that, during field trips and other school activities, all adult attention is focused on keeping our students safe as they participate in the various educational opportunities that have been planned. We encourage younger family members to attend and participate in events that are designed for family involvement.





Join the Parent Teacher Association (PTA)

We would love to have you become a member!

Contact information: www.thomaspaineppta.com

President: Jenelle Logsdon

Vice President: Carrie May-Borich

Vice President: Sara McHenry

Treasure: Jim Carver

Secretary: Amanda McKinney

PTA is a great way to be a voice and participate in your child's school. Please consider joining PTA to support our teachers and the success of your child(ren) in school.





MANDATED REPORTER **GUIDELINES**

Illinois law (Public Act 94-0888) made significant changes to reporting requirements under the Abused and Neglected Child Reporting Act (ANCRA), which imposes mandatory reporting obligations for individuals whose work involves the care and welfare of children. First, the definition of “school personnel” in the law was clarified to specifically include “administrators and both certified and non-certified school employees” as mandated reporters. Thus, almost any individual who is employed by a school or school district is required to report suspected child abuse to the DCFS Hot-line.

Possible physical indicators of child abuse:

- ⇒ **Unexplained bruises and welts** on face, lips, mouth torso, back, buttocks, thighs
 - ⇒ in various stages of healing on several different surface areas
 - ⇒ regularly appear after an absence, weekend, or vacation
- ⇒ teeth marks
- ⇒ **Unexplained burns**; such as, cigar, cigarette, especially on soles, palms, back, or buttocks
 - ⇒ patterns like electric burner, iron, etc.
 - ⇒ infected burns, indicating delay in seeking treatment
- ⇒ **Unexplained fractures/dislocations** to skull, nose, facial structure
 - ⇒ in various stages of healing
 - ⇒ multiple or spiral fractures

MANDATED REPORTER

GUIDELINES

Neglect: Denial of Critical Care



Denial of Physical Needs

Underweight, poor growth pattern (e.g., small in stature, failure to thrive)

Consistent hunger, poor hygiene, inappropriate dress

Consistent lack of supervision, especially in dangerous activities or for long periods

Wasting of subcutaneous tissues

Unattended physical problems or medical needs

Abandonment

Abdominal distention

Denial of Emotional Needs

Lags in physical, socio-emotional or intellectual development

Failure to thrive

Shallow, empty facial appearance

It is our responsibility to keep each child safe!

CRISIS DRILLS

Quick Cheat Sheet

LOCKDOWN – Intruder in the building

REALIZE WHAT SITUATION YOU ARE IN AND ACT

DECISION:

Evacuate/Run

or

Hide

- Give clear instructions to your students to run & which direction
- Once clear of the building & safe, take attendance
- Notify Mrs. Lloyd or Mr. Sanders of your location

- Lock your door(s), close blinds & cover windows, barricade door, silence phones
- Take attendance & wait for further instructions

Fight

- Use anything as a weapon and defend yourself

LOCKDOWN – Crisis in the neighborhood, potentially dangerous

ACTION REQUIRED:

- Lock your door(s), close blinds, and take cover
- Take attendance and wait for further instructions

SOFT LOCKDOWN – Situation requiring limited hallway or office access

ACTION REQUIRED:

- Lock your door(s), continue teaching

CRISIS TEAM ACTIONS:

- Sweep assigned areas
- Check for doors locked
- Come to the office

Crisis Team Member Responsibilities when called:

- Alaina Nott – sweep primary hall
- Andrea Alghalith – sweep intermediate hall
- Kim Ford – check outside south area
- Kevin Sanders – check east playground, gym
- Taloya Walker and Latrice Willis - check east hall

*Mr. Kevin Sanders – may be dispatched to designated location to meet UPD with school keys.

Spring 2019

SYMBOL LEGEND

- PAINTED LINE
- BARRIER WITH A LINE
- DOOR SW
- WALL WITH DOOR SW
- TRAILER, DETECTOR
- SMART METERING
- RECEIVED TRANSMITTER HEAD
- SURVEY WITH TRANSMITTER HEAD
- WALL WITH TRANSMITTER HEAD
- SPECIAL STRIKE ALARM DEVICE
- 553 - 104 OF 104 REGISTER
- 222 FIRE ALARM/NOTICE PANEL
- FIRE ALARM MONITORING
- BARRIERS ON SMOKE SENSORS
- BARRIERS ON SMOKE SENSORS
- BARRIERS ON SMOKE SENSORS
- FLOOR ELEVATIONS

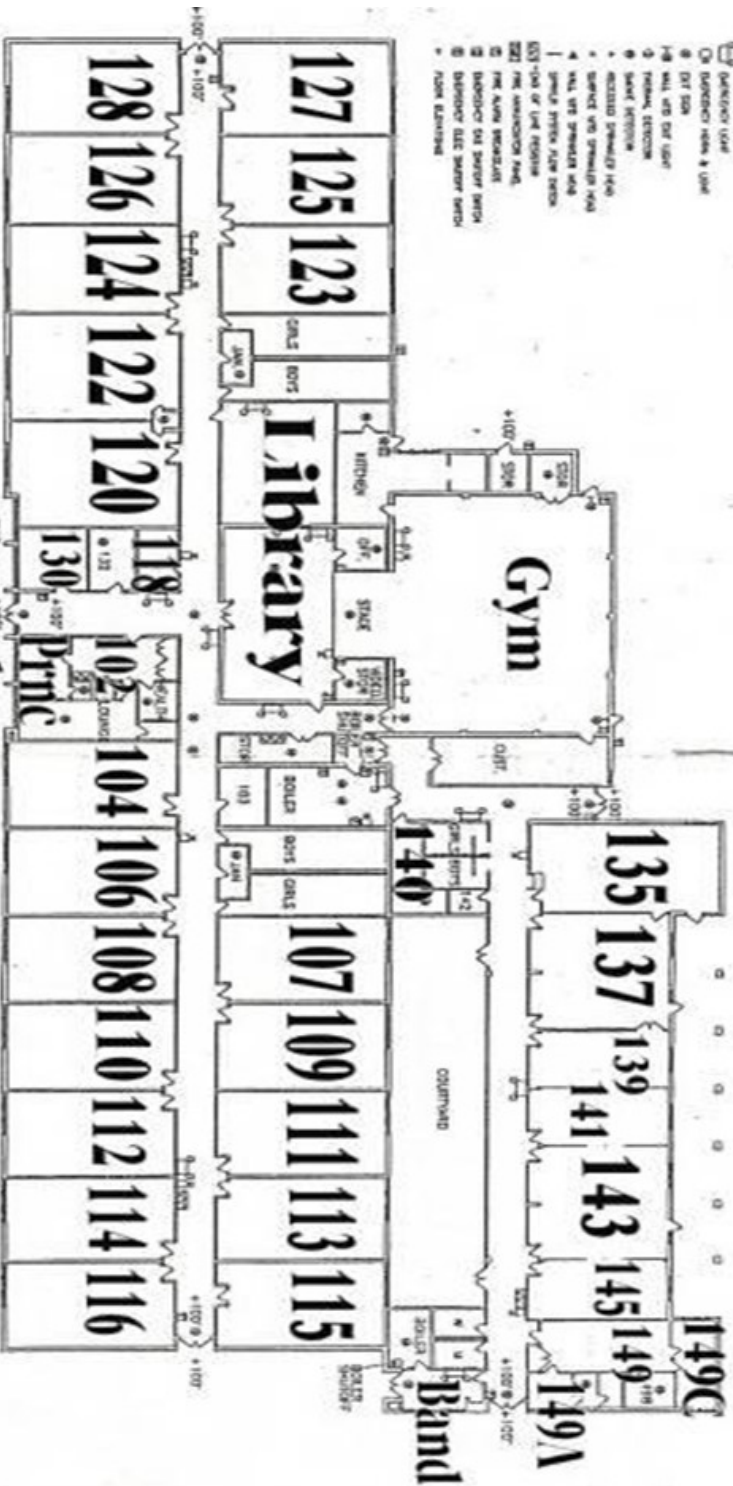

Front door

THOMAS-PAINES SCHOOL

GRIFFIN CONTRACT AND ASSOC ARCHITECTS PC / 505 PINE / 1 MARCH 1991

PROJECT:	THOMAS-PAINES SCHOOL REPAIR
DATE:	11/15/90
DRAWN BY:	J. H. WOOD
CHECKED BY:	J. H. WOOD
APPROVED BY:	J. H. WOOD
DATE:	11/15/90



GENERAL SUPPLY LIST

For specific requests, you will be given time after the start of school for those requested items. Teachers may request students to bring additional supplies to school as the year progresses. All classes must have a pair of tennis shoes for PE.

Please make sure all markers are odorless.

Kindergarten –2 lg. box tissues, 4 box 24 Crayola brand crayons, 4 box Crayola Washable thick **Classic** Color Markers, back pack (lg. enough for at least a 9X12 folder), 12 glue sticks, 2 pkg. #2 yellow pencils, 2 pink erasers, 2-2 pocket plastic folders, 1 pkg. dry erase markers, 1 wide ruled notebook, 1 pkg. Wet wipes, (bleach free) 1 bottle hand sanitizer, 1 box sandwich size Ziploc bags, 1 box gallon size Ziploc bags, 1 pair Fiskars scissors, 1 pair headphones. **NOTE: PLEASE BUY TYPES/BRANDS INDICATED TO HELP IN TEACHING COLORS.**

Grade 1 – 2 lg. box tissues, 3 plastic folders (1 of each color: blue, green, and yellow), 2 boxes of Crayola 24 count crayons, 2 boxes of Crayola Classic colors markers (2 thick), 48 sharpened # 2 pencils (preferably high quality such as Ticonderoga), 12 glue sticks, 2 pkg. Quartet dry erase markers, 4 pink erasers, 1 pair Fiskars scissors (round end), pencil box, 3 pkg. 4 pkg index cards standard size. Small dry erase board, 1 pkg. wet wipes (Bleach Free), head phones. **Please no names on supplies. All items are to be plain colors, no designs.**

Grade 2 – 2 box tissues, 6 glue sticks, No liquid glue. 36 #2 pencils, 1 box 24 crayons, scissors, 1 pkg. pencil top erasers, 2 set Quartet dry erase markers (4 color set), 1 box Crayola washable markers(Thick), 1 wide ruled composition books, plastic box for supplies, 6-2 pocket folders without brads (1 each-red, blue, yellow, green, black, orange) 2 Spiral single subject wide ruled notebook, headphones.

GENERAL SUPPLY LIST

SCHOOL SUPPLIES CLIPART



Grade 3 - 2 box tissues, Four 2 pocket folders (without brads), 3 notebooks, 1 composition notebook, 40 #2 Pencils , One 2”in binder, 2 pkg. notebook paper, 4 Quartet dry erase markers, 1 box any size Ziploc bags, crayons, markers or colored pencils. 1 pkg. of 3X5 notecards, scissors, glue sticks, headphones or earbuds, 2 pkgs. Post-its, 2 containers Lysol Bacterial wipes (optional).

Grade 4 – Earbuds or headphones, 3 box tissues, 50 #2 pencils, 1 box colored pencils, 1 box thick markers, 2 pkg. notebook paper, 3 folders w/pockets, 2 pkg. glue sticks, One 2” in. binder , 1 pkg. quartet dry erase markers, 1 quart or gallon Ziploc bags, pencil box, 3 notebooks, 2 pkgs. post-its, 1 composition notebook, 1 pack notecards.

GRADE 5 – **Headphones**, 2boxes pencils, sharpener, 1box blue pens, crayons, markers, color pencils, pink eraser, 2 wide-ruled composition books, 2 packages wide-ruled paper, 3 sturdy pocket folders, scissors, 8 glue sticks, 1-1inch white binder, 12inch ruler, 2 boxes Quartet dry erase makers, 3 boxes tissues, 1 box quart or gallon zip lock bags.

Cross-Categorical Kindergarten-Fifth – 5 boxes of tissue, Backpack, 1supply/pencil box, Fiskars scissors (round end), 1 bottle Elmer’s glue, 5 glue sticks, 1 box #2 pencils, 2 boxes Crayola Crayons, 2 boxes washable Crayola markers, 1 box multi-colored dry erase markers, 2 pink erasers, 1 box pencil top erasers, 2 boxes gallon Ziploc bags, 2 boxes quart Ziploc bags, 10 folders solid color (no name) Hand Sanitizer, Headphones, Extra change of clothes, including underwear & socks, Diapers/Pull-ups, wipes (if needed) and 1 to 2 Boxes/bags of snacks to share.

*****Please no names on materials*****

